

Instructions

- For security, please do not leave the product in excessive heat areas or expose in moist conditions.
- WARNING:** Avoid storing the lamp where there are corrosive chemicals.
- Please have the product checked by an authorized service or agent if your product has a problem. The malfunctions caused by your no allowed disassembling are not under the warranty.
- The product is certificated by RoHS and CE. Please operate the product in full compliance with the operation standards. Please note that this warranty does not apply to repairs arising from malfunction, although you may request such repairs on a chargeable basis.
- The instructions and information in this manual are based on thorough, controlled company testing procedures. Further notice will not be given if the design change.

Components

1. Light

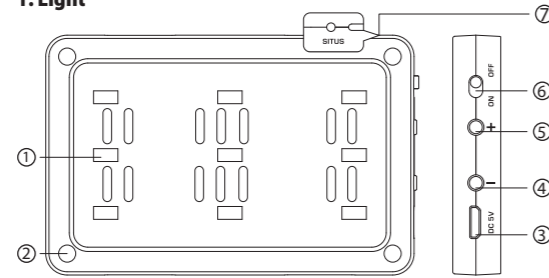

- ① Lamp beads
- ② Magnet column
- ③ USB Charging Port
- ④ Brightness “-” button
- ⑤ Brightness “+” button
- ⑥ Power switch
- ⑦ Indicator

-1-

2. Accessories

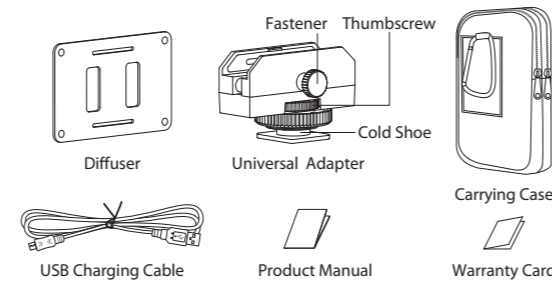

Installation

1. Install the diffuser on the lamp body.

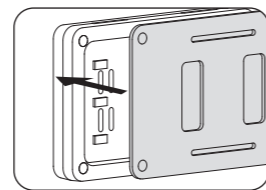

2. Place the lamp in the universal adapter, then fix the screw clockwise.

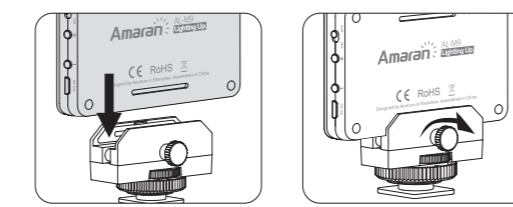

-2-

3. Diagram

1) Install the lamp with cold shoe.

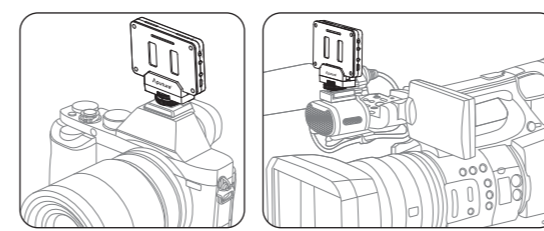

2) Disassemble the cold shoe, then use the thumbscrew to install the lamp with 1/4 screw into camera's 1/4 screw hole.

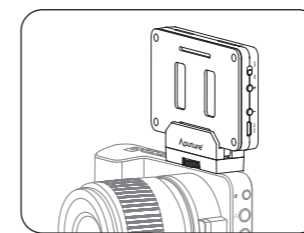

3) Handheld

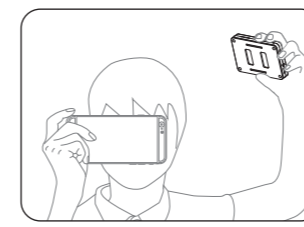

-3-

Operations

1. Charging

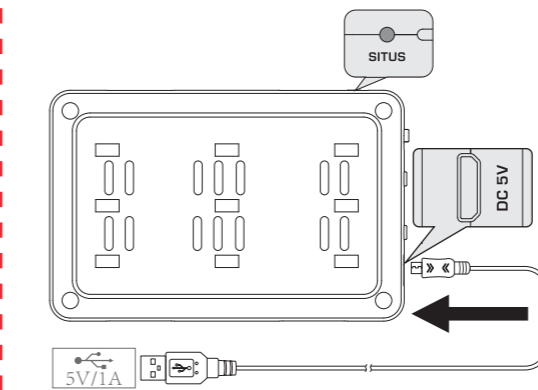

- * The indicator lights red in charging, then goes off when the lamp is fully charged.
- * The indicator flashes red a few times, the lamp will automatically shut down.
- * The indicator lights blue in working time.

2. Power ON/OFF

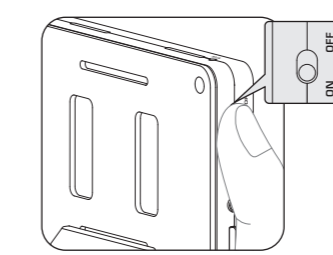

-4-

3. Adjust the Brightness

Short press “+” and “-” buttons to change the brightness, long press “+” or “-” buttons to switch the brightness quickly.

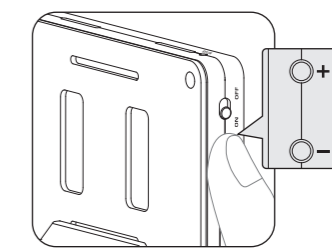

Specifications

Color Temperature	5500±200K			
CRI	>95			
TLCI	>95			
Illuminance	Distance	0.3 m	0.5 m	1 m
	Brightness	≥900LUX	≥350LUX	≥80LUX
Number of LEDs	9			
Battery Type	Lithium-polymer battery(3.7V 1800mAh)			
Voltage	DC 5V			
Current	1A			
Battery Working Time	>1.75h (maximum brightness)			
Dimension	87*56*11 mm			

Detailed product manual for AL-M9 can be found on the movie solution page on www.aputure.com.

-5-

重要提示

- 为了您的安全, 请勿将产品放置在温度过高或潮湿的地方。
- 警告:** 请勿将产品放置于有腐蚀性化学物品的地方, 以免产品被腐蚀损坏。
- 本产品内有精密电子线路, 需要维修时请联系授权的维修人员, 未经许可擅自拆卸导致产品故障, 不在本公司保修范围内。
- 本产品已经过RoHS、CE认证, 请参考相关国家标准使用和操作。因使用操作不当而造成机器损坏, 不在保修范围内, 但用户可以付费维修。
- 此使用者指南书依据本公司严格测试制定。设计和规格如有变更, 恕不另行通知。

各部件名称

1. 灯体

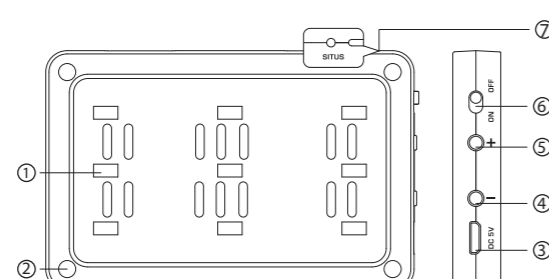

- ① 灯珠
- ② 磁铁柱
- ③ USB充电接口
- ④ 亮度减少键
- ⑤ 亮度增加键
- ⑥ 电源开关键
- ⑦ 指示灯

-1-

2. 附件

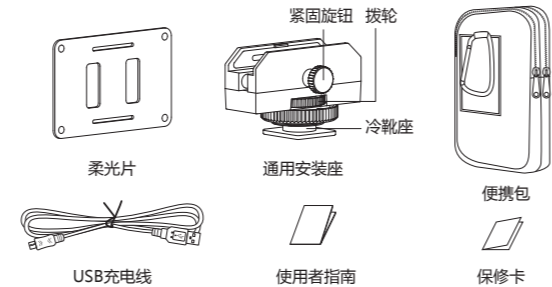

安装

1. 把柔光片孔位对准灯体的磁铁吸附位置将其安装于灯体上。

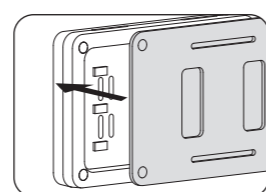

2. 将灯体组件放置于通用安装座中, 顺时针方向旋转紧固旋钮固定。

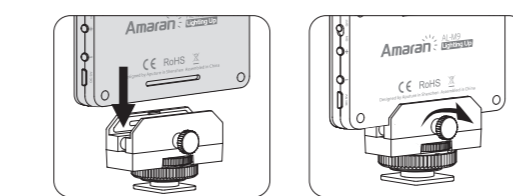

-2-

3. 安装使用示意图

1) 用冷靴座安装

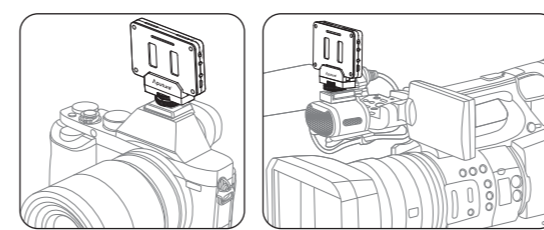

2) 通用安装座卸掉冷靴座, 用1/4螺丝通过拨轮安装在有1/4螺孔的相机上。

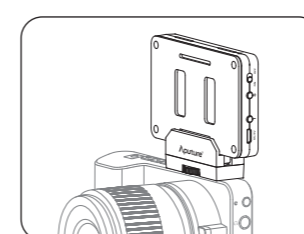

3) 手持使用

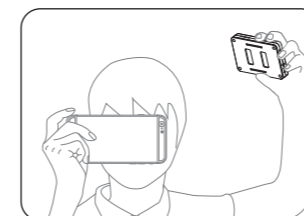

-3-

操作

1. 充电

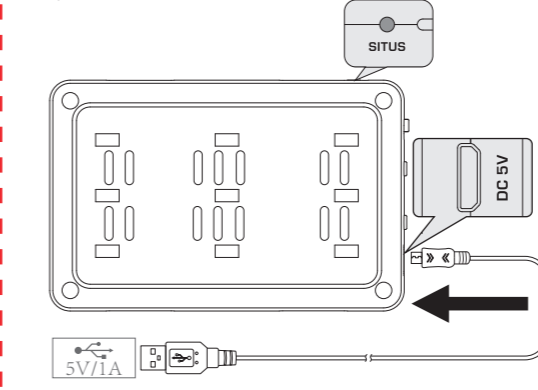

- * 充电过程, 指示灯亮红色, 充满电后, 指示灯会自动熄灭;
- * 低电时, 指示灯闪烁红色几下提示后, 自动关机;
- * 正常工作状态, 指示灯亮蓝色。

2. 开/关机

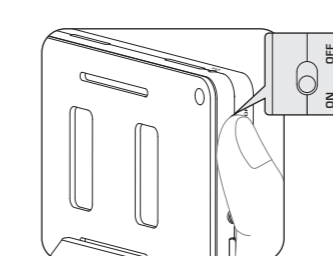

-4-

3. 亮度调节

短按“+”或“-”键, 进行亮度调节, 共9级。长按“+”或“-”可快速调节亮度。

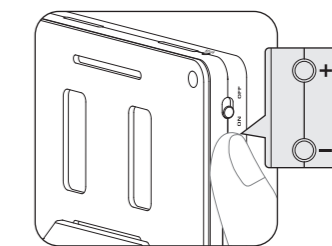

规格

色温	5500±200K			
CRI	> 95			
TLCI	> 95			
照度	距离	0.3 m	0.5 m	1 m
	亮度	≥900LUX	≥350LUX	≥80LUX
灯珠数量	9			
电池类型	锂聚合物电池 (3.7V 1800mAh)			
充电电压	DC 5V			
充电电流	1A			
电池工作时间	> 1.75h (最大亮度)			
尺寸	87*56*11 mm			

您可以在本公司网站 www.aputure.com.cn 中的炫彩视频系列产品栏目下找到本产品的详细使用者指南。

-5-

折页方式:

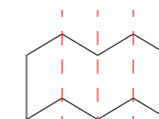

为折线(不印刷)

折页成型 (英文在正面):



Aputure® 深圳市爱图仕影像器材有限公司			
设计项目	038 说明书	图号	AP-038-PR-02
尺寸 (mm)	480*120mm 折页尺寸: 80*120mm	版本	V1.0
材质工艺	70g 书纸, 正反两面印刷	设计师	宋莹玉
备注	料号: 538000300000	日期	20160225