

Thank you!

Thank you for purchasing the Aputure Light Dome SE.

Aputure's Light Dome SE is a deep softbox with Bowens mount for the Light Storm LS series and amaran COB series LED video light, and is compatible with other LED video light which with Bowens mount.

Material list



Softbox (1pc)

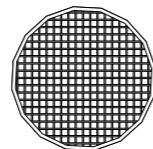

Eggcrate (1pc)

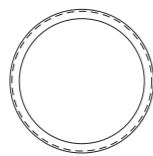

Outside Diffuser 1 (1pc)

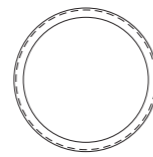

Outside Diffuser 2 (1pc)

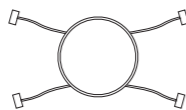

Inside Diffuser (1pc)

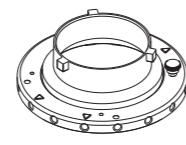

Speed Ring Adapter (1pc)



Carrying Bag (1pc)

Detailed product manual can be found on [www.aputure.com](http://www.aputure.com).

Installation

1) Speed Ring Adapter installation

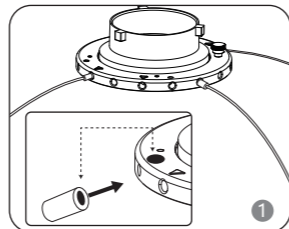

Red dot match: Insert bracket to speed ring adapter, symmetrically install all brackets.

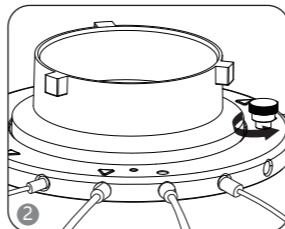

Fasten the speed ring adapter.

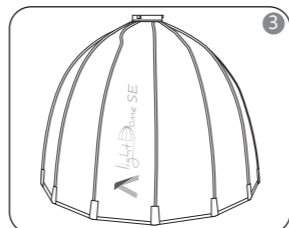

Stick magic strip well.

2) Diffuser installation

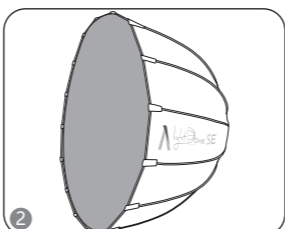
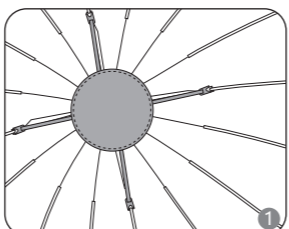

3) Eggcrate installation

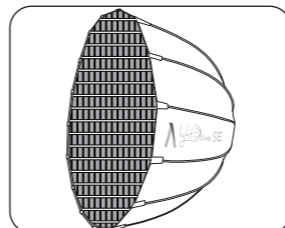

4) Light Dome SE installation

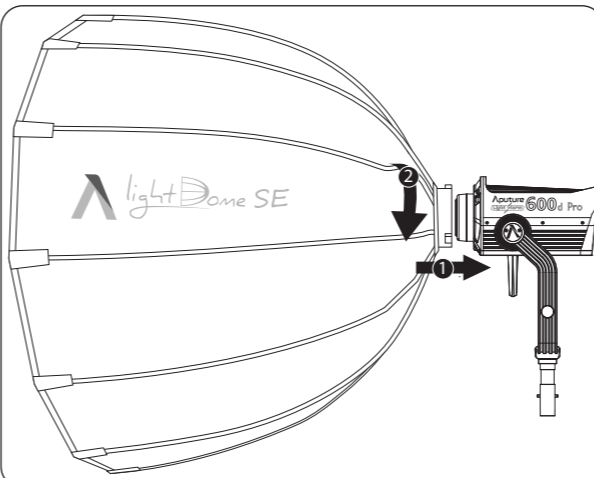

Specifications

| Item               | Dimension                     | Net Weight      |
|--------------------|-------------------------------|-----------------|
| Softbox unfolded   | Φ850mmx450mm (Φ33.46"x17.72") | 1.09kg (2.4 lb) |
| Outside Diffuser 1 | Φ820mm (Φ32.28")              |                 |
| Outside Diffuser 2 | Φ820mm (Φ32.28")              |                 |
| Inside Diffuser    | Φ240mm (Φ9.45")               |                 |
| Speed Ring Adapter | Standard Bowens Mount         |                 |
| Eggcrate           | Φ820mm (Φ32.28")              |                 |

Trademarks

Bowens is a trademark or registered trademark of Bowens in China or other countries.

This warranty is void if:  
 • The product identification or serial No. label is removed or defaced in any way.  
 • The product is serviced or repaired by any one other than Aputure or an authorized Aputure dealer or service agency.

Aputure Imaging Industries Co., Ltd.  
 Add: F/3, Building 21, Longjun Industrial Estate, Heping West Road, Shenzhen, Guangdong  
 E-MAIL: [cs@aputure.com](mailto:cs@aputure.com)  
 Sales Contact: (86)0755-83285569-613

**This warranty does not cover:**  
 • Damage that is the result of misuse, abuse, accident (including but not limited to damage by water), faulty connection, defective or misadjusted associated equipment, or the use of the product with equipment for which it was not intended.  
 • Cosmetic defects that appear more than thirty (30) days after the date of purchase. Cosmetic damage caused by improper handling is also excluded.  
 • Damage that occurs while the product is being shipped to whoever will service it.

**Important:**  
 Keep your original sales receipt. Be sure the dealer has written on it the date, serial No. of the product. This information is required for warranty service.

**Service Warranty (EN)**  
 Aputure Imaging Industries Co., Ltd. warrants the original consumer purchaser from defects in material and workmanship for a period of one (1) year after the date of purchase. For more details of warranty visit [www.aputure.com](http://www.aputure.com)

Aputure®  
 Aputure Imaging Industries Co., Ltd.  
 Inspection: Qualified  
 Add: F/3, Building 21, Longjun Industrial Estate, Heping West Road, Shenzhen, Guangdong

| Serial No. | Item Name | Purchase Date | Buyer Name | Buyer Phone | Buyer Add | Franchiser Seal |
|------------|-----------|---------------|------------|-------------|-----------|-----------------|
|            |           |               |            |             |           |                 |

Aputure®  
 GUARANTEE CARD

折页方式:

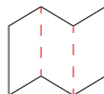

为折线(不印刷)

折页成型 (英文在正面):



| Aputure 深圳市爱图仕影像器材有限公司 |                          | 图号  | AP-216-PR-01 |
|------------------------|--------------------------|-----|--------------|
| 设计项目                   | 216 说明书                  | 版本  | V1.0         |
| 尺寸 (mm)                | 450*140mm 折页尺寸: 90*140mm | 设计师 | Ingold       |
| 材质工艺                   | 70g 书纸, 正反两面印刷           | 日期  | 20201027     |
| 备注                     | 料号:                      |     |              |

感谢!

感谢您购买爱图仕多用途抛物线反光罩特别版。

爱图仕多用途抛物线反光罩特别版采用标准保荣卡口，是一款搭配爱图仕“光·风暴”LS系列及Amaran系列COB影视灯并同时兼容其他品牌保荣卡口影视灯的产品。

物品清单



柔光箱 (1pc)

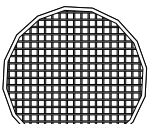

格栅 (1pc)

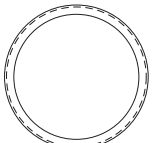

外部柔光布1 (1pc)

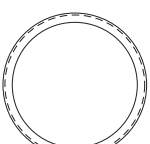

外部柔光布2 (1pc)

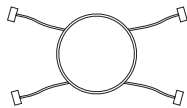

内部柔光布 (1pc)

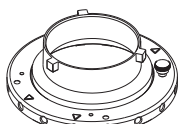

卡盘 (1pc)



手提包 (1pc)

您可以在本公司网站 <http://www.aputure.com/cn> 下载本产品的详细使用者指南。

安装方式

1) 安装卡盘

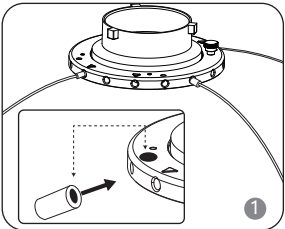

红点标识支撑杆插入对应红点卡盘孔，对称安装所有支撑杆。

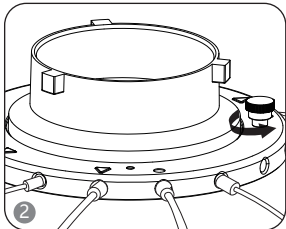

旋紧固定手柄

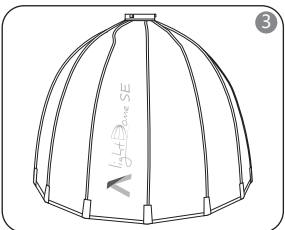

粘好魔术贴

2) 安装柔光布

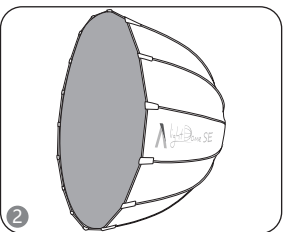
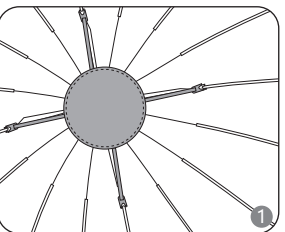

3) 安装格栅

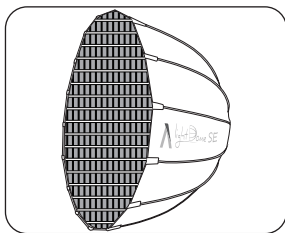

4) 安装至灯体

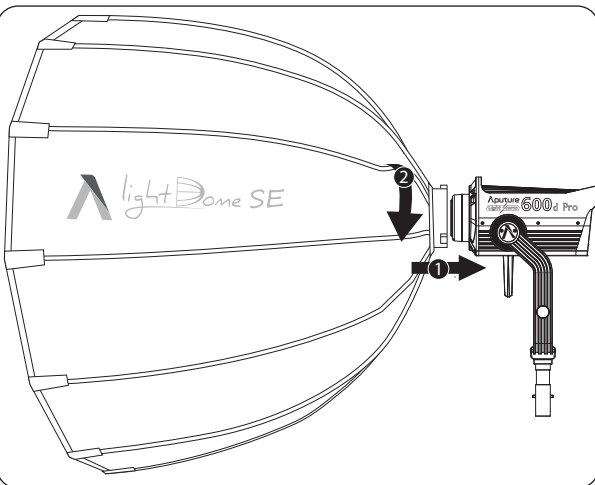

规格参数

| 物料      | 尺寸                            | 净重              |
|---------|-------------------------------|-----------------|
| 柔光箱打开状态 | Φ850mmx450mm (Φ33.46"x17.72") | 1.09kg (2.4 lb) |
| 外部柔光布1  | Φ820mm (Φ32.28")              |                 |
| 外部柔光布2  | Φ820mm (Φ32.28")              |                 |
| 内部柔光布   | Φ240mm (Φ9.45")               |                 |
| 卡盘      | 标准保荣卡口                        |                 |
| 格栅      | Φ820mm (Φ32.28")              |                 |

商标声明

Bowens是保荣公司在中国或其他国家的商标及产品型号。

**重要说明:**  
请保留您原始购买单据及保修卡, 确定您购买的供应商资料都在此单据, 同时包括您的购买日期, 产品序列号等, 这些资料质保服务时都会需要提供。

**质保范围不包括:**

- 产品不当使用, 破坏, 意外, 错误接线, 不良或失调的外接装置, 在质保范围。
- 不适合的外接装置所造成的损坏(包括暴露于雨水等损坏), 不在质保范围。
- 自购买日30天后产品外观的损伤, 或是不当的表面处理接触造成的外观损伤, 不在质保范围。
- 经销商运送所造成的损坏, 不在质保范围。

**质保无效说明:**

- 产品序列号标识已经被撕去或无法辨识, 本质质保无效。
- 产品未经本公司或者指定授权维修公司的检修及改装, 本质保条款无效。

深圳市爱图仕影像器材有限公司  
地址: 广东省深圳市龙华和平西路九窝龙军工业区2栋3楼  
邮箱: [cs@aputure.com](mailto:cs@aputure.com)  
销售热线: 0755-83285959-613  
服务热线: 400-0999-028

深圳市爱图仕影像器材有限公司  
检验: 合格  
地址: 深圳市龙华新区和平西路九窝龙军工业区

| 产品编号 | 产品名称 | 购买日期 | 用户姓名 | 用户电话 | 用户地址 | 经销商印章 |
|------|------|------|------|------|------|-------|
|      |      |      |      |      |      |       |

本公司对产品第一买家客户提供为期一年的质量保证期, 质保内容和细节, 请登陆我们的网站[www.aputure.com](http://www.aputure.com)。